

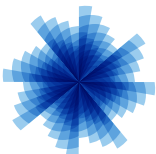

Complex
Desalination
Made Simple

Modular Prefabricated SWRO Desalination Solution



IDE
Technologies

Your
Water
Partners

Desalinating Water
Since **1965**
With Excellence

Complex Desalination Solutions Just Got Simpler Than Ever Before

We at IDE are tuned to our customers' ever changing requirements and constrains. For this reason, we developed the IDE Modular Prefabricated Design (MPD) philosophy - a platform that provides a simple and flexible designs to a range of desalination plants.

With our MPD prefabricated modules, all manufacturing and testing work is completed in off-site workshops and in QA/QC controlled environments, minimizing on-site work and ensuring the highest standards. As the design is modular, your plant can easily be expanded in the future to meet your changing needs, by using the module's existing capacity or adding additional modules.

Our MPD concept provides a perfect solution for a variety of needs, where RO is the technology of choice. The MPD is available in a range of sizes - from 1,600 m³/day complete RO systems, equipped with integrated pretreatment, and up to prefabricated modules for mega size RO plants. The MPD maximizes off-site prefabrication for fast installation and minimal on-site labor.

MPD SWRO Systems | 1,600 - 5,000 m³/day

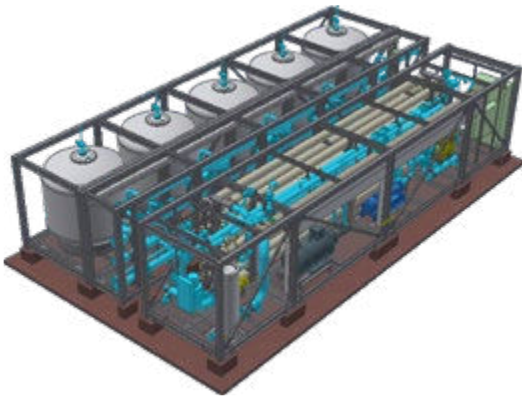

1,600 - 2,000 m³/day

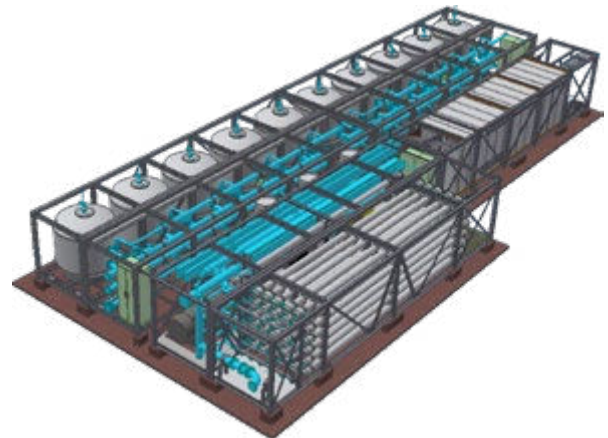

3,500 - 5,000 m³/day

MPD design is suitable for large scale desalination SWRO plants

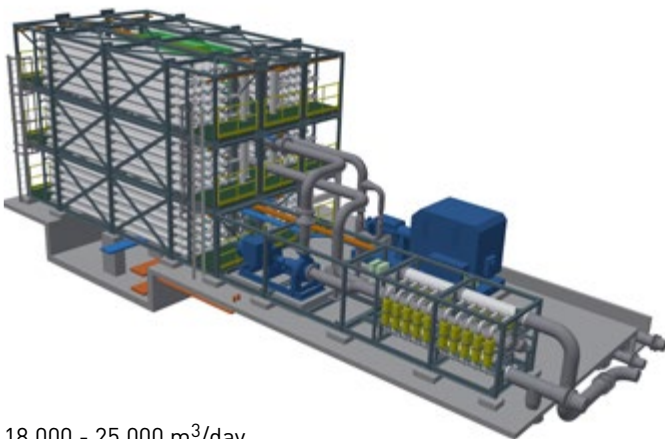

18,000 - 25,000 m³/day

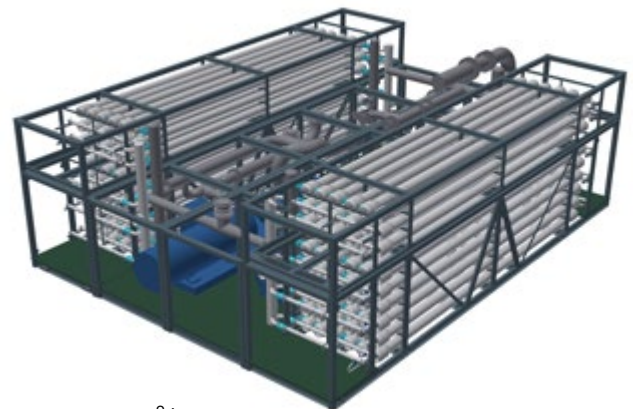

8,500 - 12,500 m³/day



Complex
Desalination
Made Simple

Main References

- **Jurong Island Desalination Plant, Singapore**
Capacity: 135,000 m³/day (35 MGD) | To be commissioned: 2020
- **Formosa Group, Taiwan**
Capacity: 105,000 m³/day (27.7 MGD) | To be commissioned: 2020
- **Quebrada Blanca, Chile**
Capacity: 102,360 m³/day (27 MGD) | To be commissioned: 2020
- **Oteko, Russia**
Capacity: 2 x 5,500 m³/day (2.9 MGD) | Completed: 2018
- **Santa Barbara, USA**
Capacity: 10,500 m³/day (2.8 MGD) | Commissioned: 2017
- **WEB Bonaire, Bonaire Island**
Capacity: 5,600 m³/day (1.23 MGD) | To be commissioned: 2020
- **Koh Tao Water, Thailand**
Capacity: 1,000 m³/day (0.3 MGD) | Commissioned: 2015
- **Mulpha Hotels, Hayman Island, Australia**
Capacity: 1,000 m³/day (0.3 MGD) | Commissioned: 2014



Lower Risk - Higher ROI

Lower Risk



- Full prefabrication & testing in the workshop
- Reduced site works
- Fast delivery & shorter execution schedule

Higher ROI



- Pre-set for future expansion
- Minimal expenses related to infrastructure and civil works

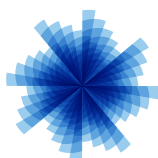

IDE
Technologies

Your
Water
Partners



From Ocean to Tap

City of Santa Barbara Refurbishes a 20-year-old SWRO Plant to Meet 21st Century Needs

Exceptional drought conditions demand exceptional thinking, and in July 2015 the City of Santa Barbara decided to refurbish its old plant, which had been in long-term standby mode since 1991. Significant engineering was required to bring the plant online and provide a substantial contribution to the city's challenging water needs, independent of the constant threat of drought.

The 10,560 m³/day (2.8 MGD) plant was commissioned in late 2017, with the option to expand to a capacity of 25,344 m³/day (6.7 MGD). The plant currently provides 30% of the city's water supply.



IDE - Over 50 Years of Experience

Sustainability. Resilience. Community.

A world leader in desalination and water treatment solutions, IDE is at the forefront of the development, engineering, construction and operation of enhanced desalination, industrial water treatment and water reuse facilities. IDE's headquarters are in Israel, with offices in the USA, China, India, and Chile, facilitating client partnerships across the globe.

- Proven and robust water treatment technologies that provide our clients with end-to-end solutions
- Developed some of the most advanced membrane-based and thermal solutions
- Designed, built and operates some of the world's largest desalination plants
- Successful implementations in more than 400 plants in over 40 countries



**MIT Technology
Review 2015 -16**

50 Smartest Companies



**2016 Fortune
Change the World List**

2nd place

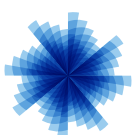

IDE
Technologies

Your
Water
Partners

